

MADE IN GERMANY

# Eagle Accessories

## The agile solution for closely built-up PV parks

In combination with the crawler chassis, the Eagle offers the perfect solution for particularly confined PV installations and narrow aisles. This combination cleans even the most inaccessible PV parks with tables of up to 4 meters.



# / Xplorer

The Xplorer is a powerful crawler chassis which, in conjunction with the Eagle, has been specially developed for use in closely built-up photovoltaic parks and narrow aisles. This combination offers a compact and efficient overall solution for the professional cleaning of 1P systems.

The Xplorer Eagle unit impresses with its high maneuverability and easy handling.

## Technical data

Track width	120 cm
Length	255 cm
Height	135 cm
Weight	1050 kg
Machine load plan	1300 kg
Maximum working humidity	90 %
Maximum angle of inclination	Gradient 25°; lateral inclination 15°
Motor	Kubota 05 series D1305-E3B; 3 cylinder 19Kw
Max. Pressure for hydraulic motor	200 Bar
Max. permissible oil flow speed of the hydraulics	45 l/min
Travel speed during cleaning	1,5 - 4 km/h

## Accessories



Support bracket with forks

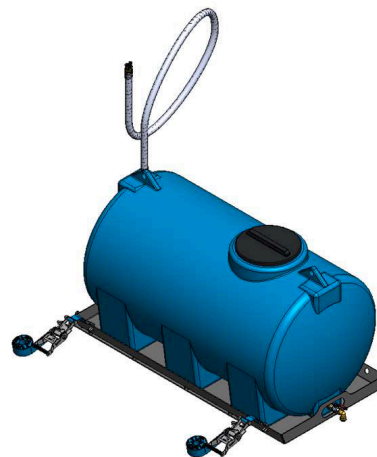

Substructure for Hippo 750 water tank with attachments

# / Support bracket & water tank



Our specially developed **carrier bracket** enables the Eagle to be mounted easily and safely on a wide variety of carrier vehicles. The console can be used as a single component or can optionally be combined with an integrated water tank, which is mounted under the console to save space. The result is a compact and well thought-out solution for **wet cleaning**.

## Accessories

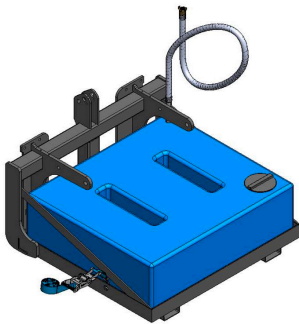

Flexi Adapter XII with attachments

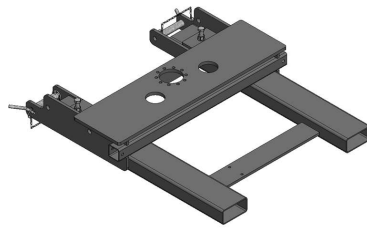

Mounting bracket

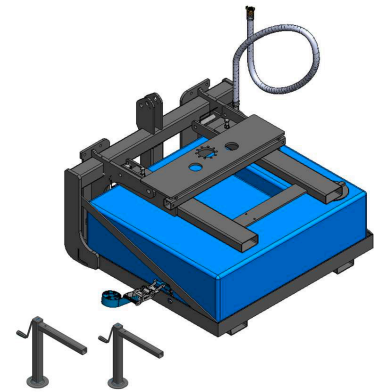

Flexi Adapter XII with mounting bracket and attachments

## Cleaning performance\*

3m Brush	Dry cleaning (2-4 km/h)	Wet cleaning (1,5 - 2,5 km/h)
Panel/h	2.000 - 4.000 St.	ca. 1.500 - 2.500 St.
Area output	4.000 - 8.000 m <sup>2</sup>	ca. 3.000 - 5.000 m <sup>2</sup>

\* Data depends on the carrier vehicle, the local conditions and the degree of soiling.



### Kontakt

sales@sunbrushmobil.com  
+49 (0) 8332 243 43 - 0  
www.sunbrushmobil.com

### SunBrush mobil GmbH

Am Bahnhof 14  
87760 Lachen



### Digital Flyer

Scan the QR code for the digital Eagle Flyer.